

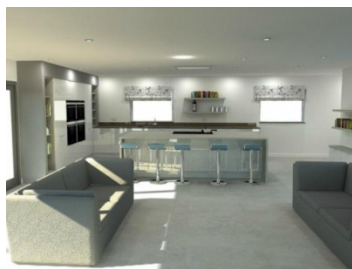

callingham
architects

Barn Conversion

Balsall Common



Contemporary Barn Conversion in exclusive Warwickshire Hamlet

Plot 1 Barretts Lane Farm is a contemporary barn conversion on an exclusive hamlet in Balsall Common of 6 dwellings

We have been involved with the master-planning of the entire development to provide a joined up scheme of contemporary and historical buildings.

Each new dwelling created required a different planning approach and this barn was approved under Class Q permitted development.

This approach allowed the early requirements of Class Q to be applied and a large single dwelling unit was possible

This unit forms one of four contemporary dwellings based on existing farm buildings where structural suitability was established for conversion

Overview

Construction Value:
£550,000

Client:
Henry Rowlands

Developer:
Henry Rowlands

Timeframe:
Jan – Sept 2017